

# MOVE-IN SCHEDULE

## Lower Level

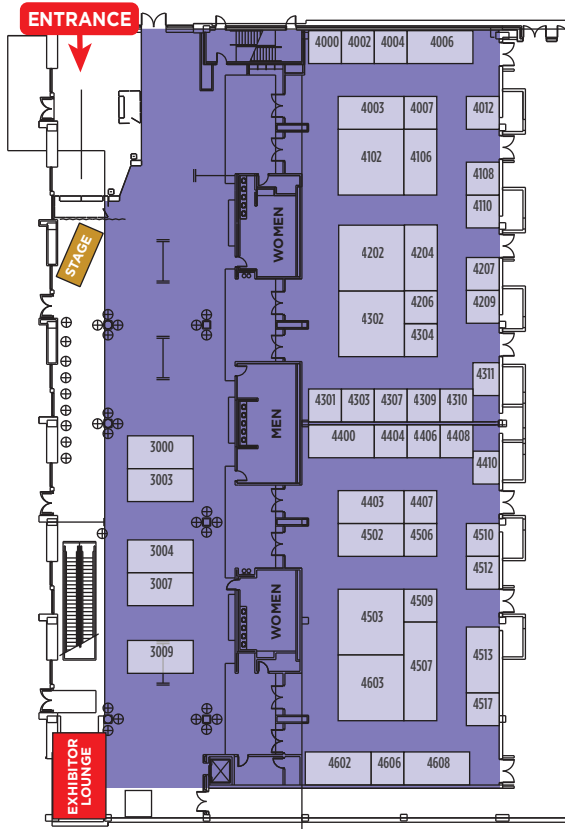

## Upper Level



KANSAS CITY

*Holiday*

BOUTIQUE

SINCE 2011

**NOV. 18-22, 2026**

Overland Park Conv. Center

[KCHolidayBoutique.com](http://KCHolidayBoutique.com)

- MON 12 p.m. - 6 p.m.
- TUE 8 a.m. - 2 p.m.
- TUE 2 p.m. - 7 p.m.
- WED 8 a.m. - 3 p.m.

No diving vehicles into the building starting Wednesday.

Aisle carpet in the Exhibit Hall will be put down at 8 a.m. on Wednesday.

All booths must be completely setup by 3 p.m. on Wednesday for VIP night that starts at 5 p.m.