

# 2024 Edmonton Fall Home Show

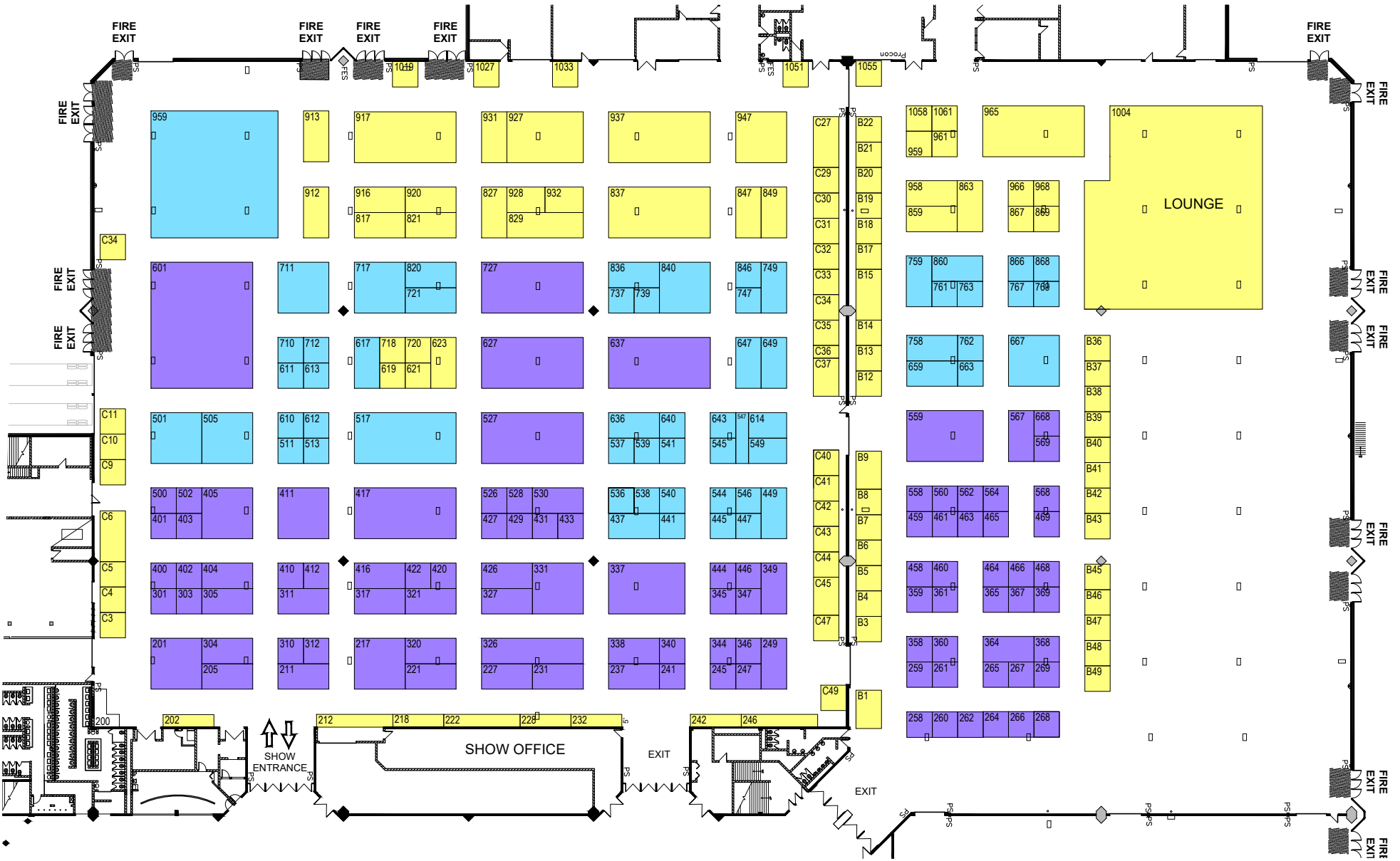

- OCT 16 8AM-1PM
- OCT 16 1PM-8PM
- OCT 17 8AM-4PM

\*please note that all freight and equipment must be out of the aisles by 4PM on Oct 17 for the installation of aisle carpet.

Every attempt will be made to accommodate your unloading time. GES will confirm all target changes in writing.

If you cannot adhere to your assigned schedule and wish to request a change, please send a written request to: GES (email): gjorgenson@ges.com.



## Edmonton Expo Centre

\*Floor Plan Subject to Change