

# MOVE-IN SCHEDULE - EAST HALL

- Thursday, Feb. 27th**
- 7:00 a.m. - 9:00 a.m.
  - 10:00 a.m. - 11:30 a.m.
  - 12:00 p.m. - 1:30 p.m.
  - 2:00 p.m. - 3:00 p.m.
  - 3:30 p.m. - 4:30 p.m.
  - 5:00 p.m. - 6:30 p.m.

\*\*Only Vendors with booth assignments in the first move-in time (PINK) may come on Wednesday, February 26th between 3 p.m. - 7 p.m. to unload early.\*\*



**FEBRUARY 28 -  
MARCH 2, 2025**  
THE BJCC



**Check-in  
HERE for  
Booths  
#1 - 900**



ART, CRAFTS, & GIFTS



# MOVE-IN SCHEDULE - NORTH HALL

**FEBRUARY 28 -  
MARCH 2, 2025**  
THE BJCC

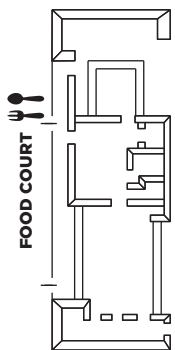

FOOD COURT

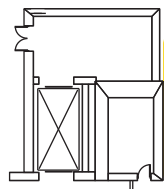

**Check-in  
HERE for  
Booths  
#1000-1931**

**LOADING  
DOCK 1**  
Drive-In  
to Unloading

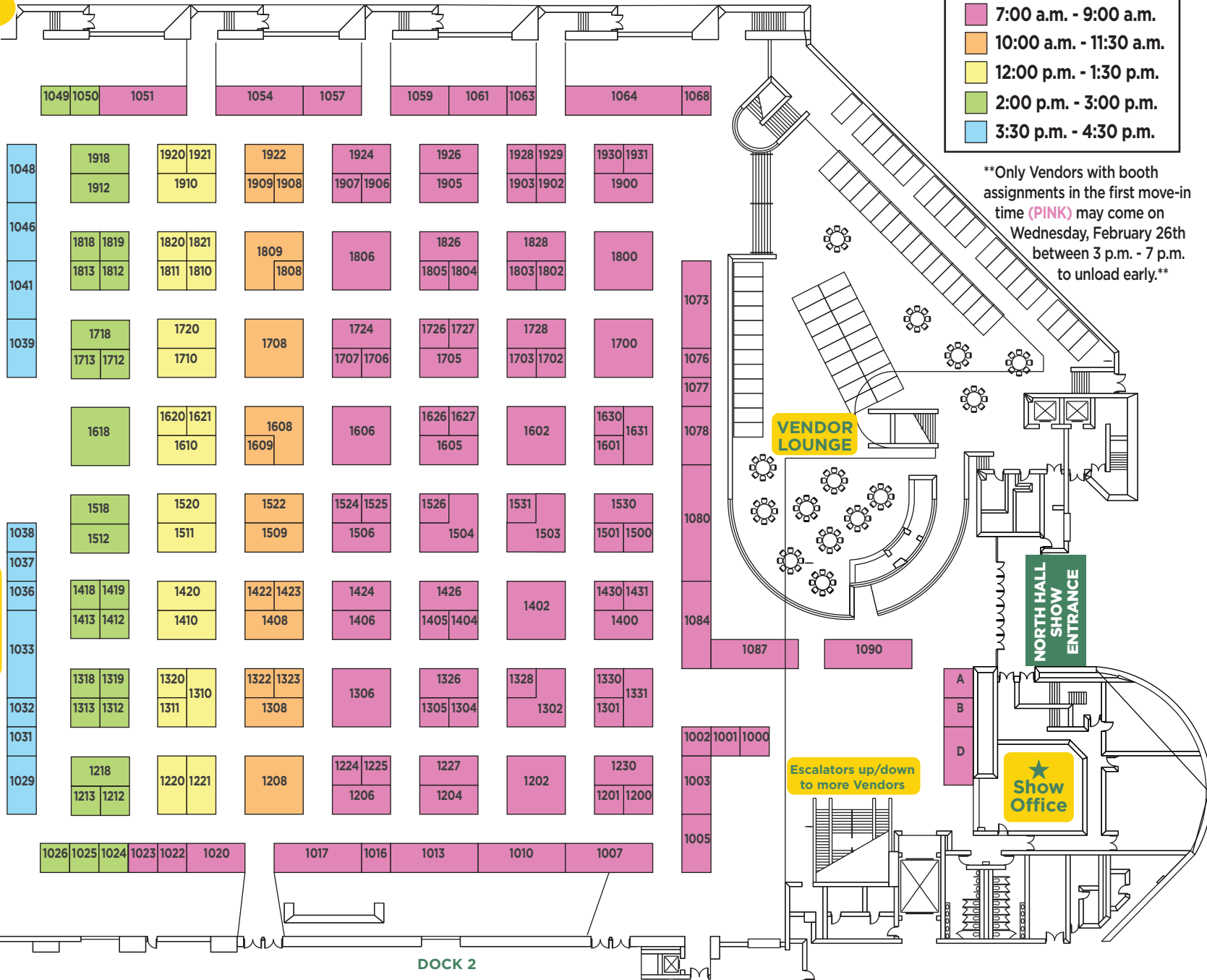

**Thursday, Feb. 27th**

- 7:00 a.m. - 9:00 a.m.
- 10:00 a.m. - 11:30 a.m.
- 12:00 p.m. - 1:30 p.m.
- 2:00 p.m. - 3:00 p.m.
- 3:30 p.m. - 4:30 p.m.

**\*\*Only Vendors with booth assignments in the first move-in time (PINK) may come on Wednesday, February 26th between 3 p.m. - 7 p.m. to unload early.\*\***